

PLEASE READ THESE INSTRUCTIONS:

THERE ARE 3 CLAMPS PER COMPARTMENT: SIX CLAMPS WITH A DOUBLE CARRIER AND THREE CLAMPS WITH A SINGLE - DETACH THE CLAMPS AND RECYCLE THE CARDBOARD PACKING.

BEFORE YOU PAINT

- Use ANY SIZE stretched canvas up to 12" x 16". Tightly attach (3) three WET-CASE® Clamps to the stretcher bars as shown in Diagram 1. The clamps will fit most standard wooden stretcher bar profiles.
- Place the canvas on your easel with the padded screw heads of BOTH bottom clamps sitting in the bottom easel bracket. Diagram 2.
- Secure the top clamp in the top easel bracket. You can use a twist tie (not included) to secure the clamp to the top bracket if it does not have a lip.
- When your canvas is mounted to the easel, you can enjoy a completely unobstructed painting surface that allows you to paint freely to ALL edges of the canvas.

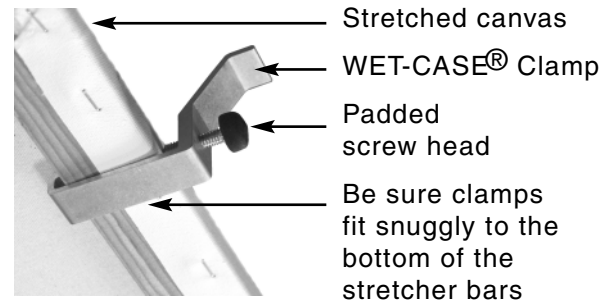

READY TO PACK UP

- First, open the Lid of the WET-CASE® Canvas Carrier as shown. Then loosen the top easel bracket and grasp the handle of the Top Clamp and the handle of one of the Bottom Clamps. No need to touch any wet paint.
- Now place your painting in the Carrier, paint side up, in the middle of the compartment as shown.
- **BE SURE to leave the Clamps attached to your painting!**

CLOSING THE CARRIER

- Guide the Tab at each corner of the Lid into the end slot.
- Then, BEFORE trying to close the lid completely, use your thumb to guide the Twist Locks through the slots in the lid.
- NOW close the Lid firmly and twist the Locks to secure it.
- Your painting is held safely away from the inside surface of the Carrier by the Clamp handles. (If you have a Double Carrier, you can turn over the Carrier to load a 2nd painting in the other compartment.)

EXTENDING CARRIER LIFE

- Keep a large plastic bag with your Carrier to protect it (and your paintings) from rain or other very wet conditions.
- Folds can be strengthened by carefully applying clear packing tape.

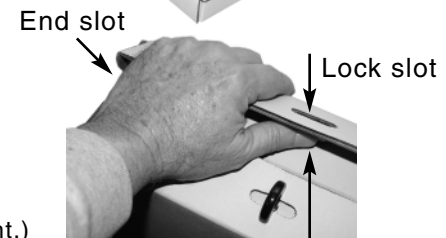
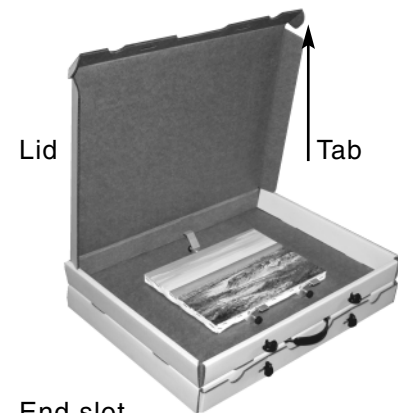
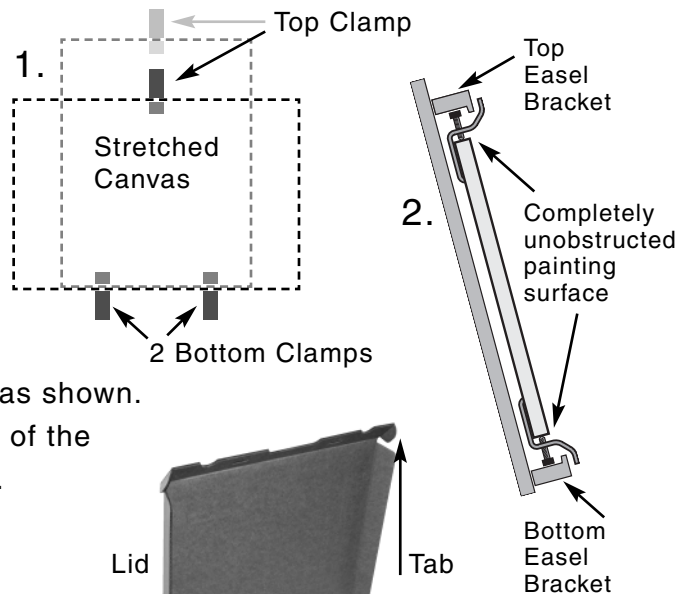

Guide Twist Lock with your thumb

Watch a **VIDEO** demonstration at our website:
www.WET-CASE.com

WET-CASE® Wet Canvas Carrying System
PATENT PENDING Made in USA

RWGROVE LLC
7672 Montgomery Road, No.151, Cincinnati, OH 45236